

Penydarren Road

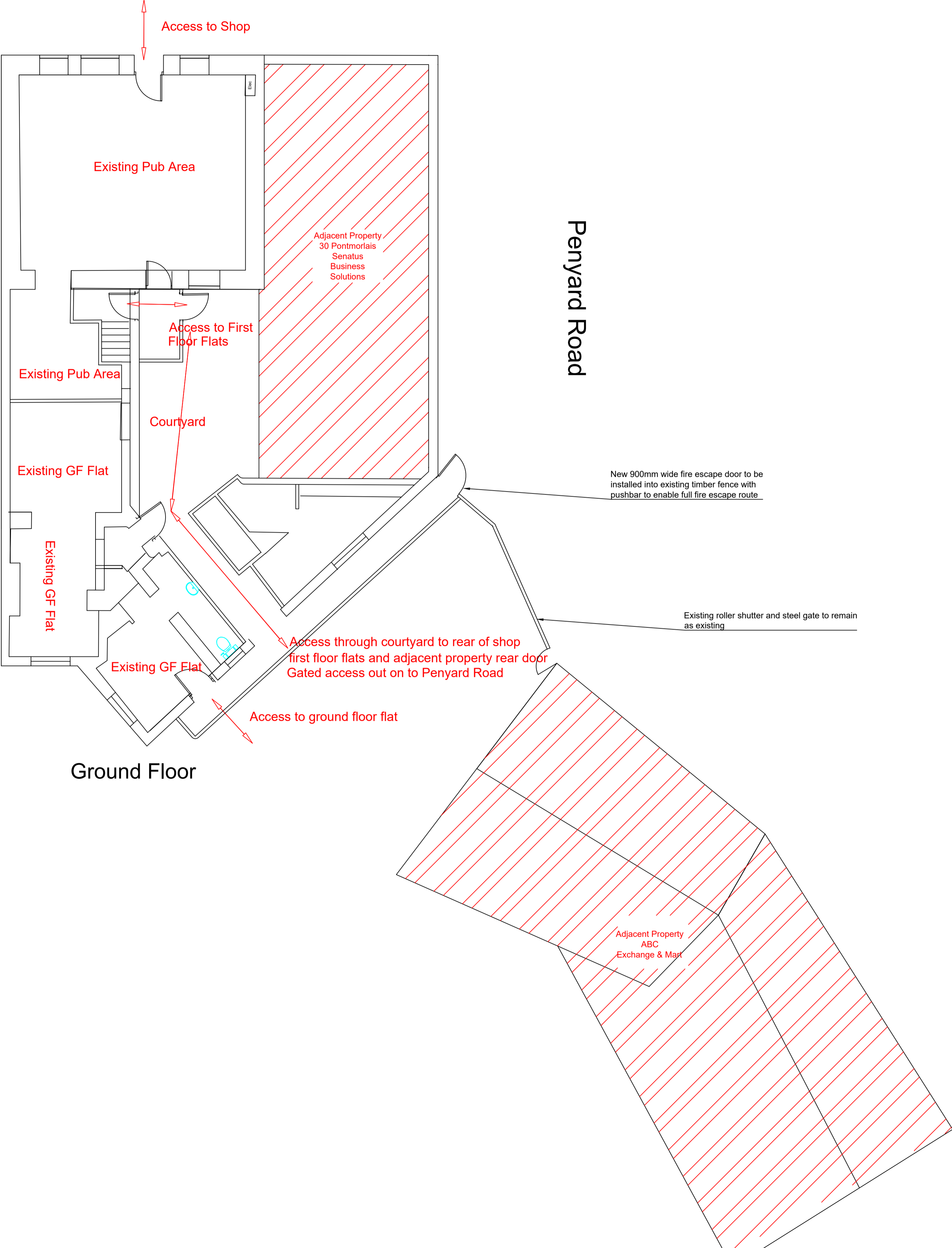

REV	DATE	INIT	REVISIONS
THIS DRAWING IS TO BE READ IN CONJUNCTION WITH THE PROJECT SPECIFICATION. ANY DISCREPANCIES MUST BE REPORTED TO THE C.A. THIS DRAWING IS IN MILLIMETRES, WORK TO FIGURED DIMENSIONS ONLY. DO NOT SCALE.			
PREMISES NAME 29 Penydarren Road Pontmorlais Merthyr Tydfil CF47 8UM			
PREMISES CODE -		PROJECT NUMBER *****	
DRAWING No. 5303-102			REV A
DATE 03/03/24	SCALE nts		DRAWN -
DESCRIPTION External Access Proposed Alterations -			