

GENERAL NOTES

STRUCTURAL PROPOSALS HAVE BEEN DRAWN ONTO THE LATEST SET OF ARCHITECTS DRAWINGS PRODUCED BY GWP ARCHITECTURE.

MEMBER SCHEDULE

- C180x80x3.6SHS (S355H) STEEL COLUMN WITH A 130mm WIDE x 150mm LONG x10mm THICK BASEPLATE, WITH 2NO. HOLES FOR M12 RESIN ANCHORS INTO THE CONCRETE FOOTING.
- B1203x102x23UB (S355) STEEL BEAM CONNECTED TO ONTO COLUMNS.
- P1300x300x250 MASS CONCRETE PADSTONE BUILT INTO EXISTING MASONRY TO SUPPORT BEAM BEARINGS.
- J

ASSUMED SPAN OF EXISTING JOISTS (AT FIRST FLOOR) BASED ON PRELIMINARY SITE INSPECTION. TO BE CONFIRMED BY MEANS OF FURTHER INVESTIGATION.
- F1400mm WIDE x 400mm LONG x 250mm THICK MASS CONCRETE (FND2) FOUNDATION BUILT ONTO EXISTING MASONRY WALL HEAD OR COMPETENT GROUND (SUBJECT TO FURTHER INVESTIGATIONS).



- NOTES
1. This drawing is copyright and may not be reproduced without the permission of Mann Williams.
2. All drawings are to be read in conjunction with the project specification with all works carried out in accordance with the latest British Standards and codes of practice.
3. Any ambiguities or discrepancies between this drawing and any other information given elsewhere must be reported to Mann Williams for clarification before work proceeds.
4. All dimensions to be checked on site and any discrepancies reported to the engineer before work commences.
5. Only figured or calculated dimensions should be used and no drawing , in any format should be scaled.

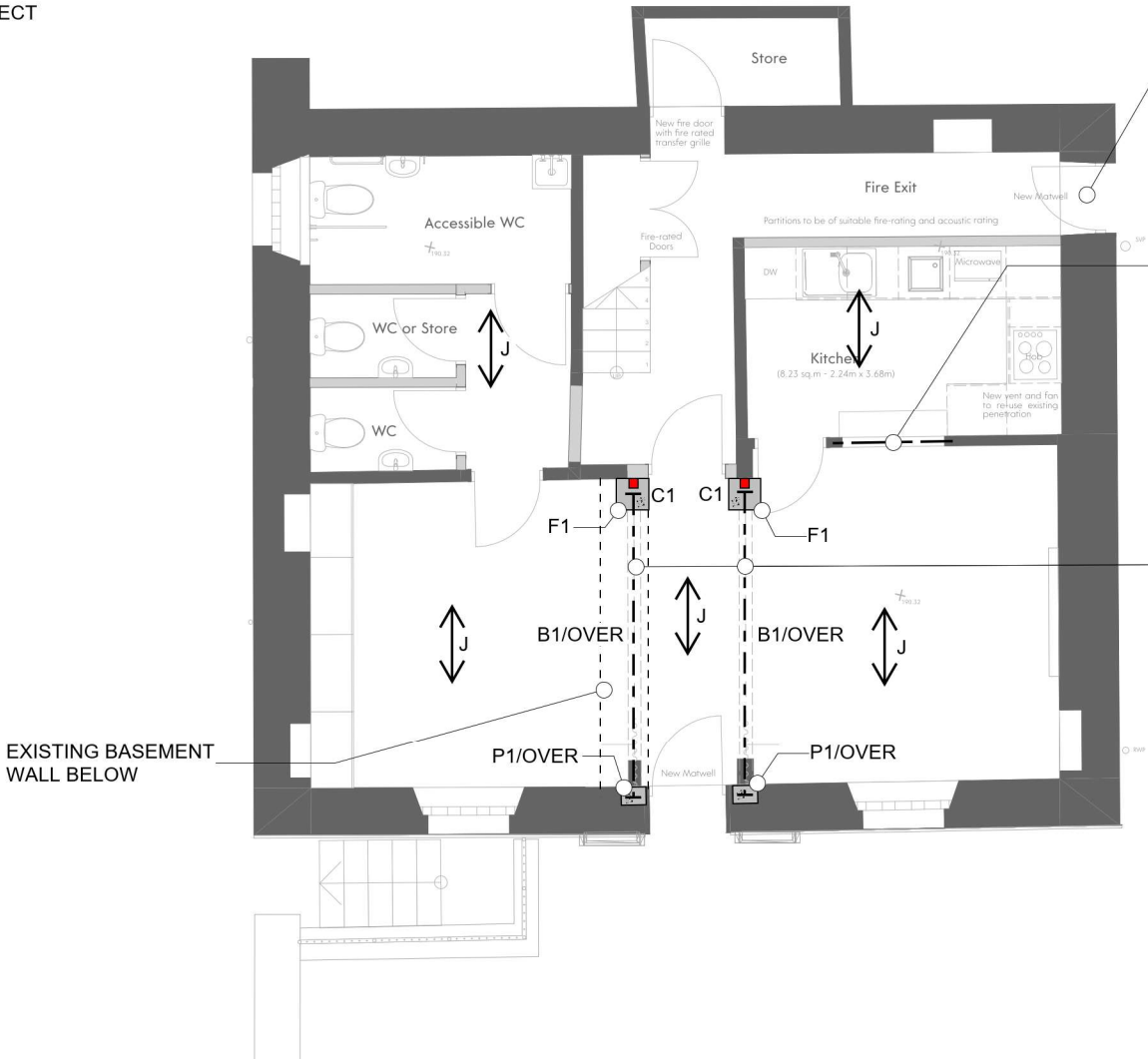

EXISTING LINTELS FOR WINDOW ARE OF UNKNOWN CONSTRUCTION AND CONDITION. PROPOSAL IS TO REINSTATE A FORMER DOORWAY HOWEVER WE RECOMMEND AN ALLOWANCE IS MADE FOR REMOVING EXISTING LINTELS AND REPLACING WITH SAY 5NO. 100mm WIDE x 140mm DEEP PRECAST CONCRETE LINTEL (NAYLOR ECONOMY) OR SIMILAR APPROVED.

PROVIDE 100mm WIDE x 140mm DEEP PRECAST CONCRETE LINTEL (NAYLOR ECONOMY) OR SIMILAR APPROVED FOR PROPOSED SERVICE HATCH. FIRE RATING OF LINTELS TO BE CONFIRMED BY THE ARCHITECT OR APPOINTED FIRE ENGINEER.

FOUNDATIONS FOR EXISTING MASONRY WALLS IS UNKNOWN AND SHOULD BE CONFIRMED WITH THE UNDERTAKING OF A TRIAL PIT AT GROUND FLOOR LEVEL.

ALLOW FOR EXCAVATING 2NO. LOCALISED 500mm SQUARE x 1m DEEP TRIAL PITS ON ONE SIDE OF THE EXISTING BRICK WALLS TO CONFIRM FOUNDATION DEPTH AND CONSTRUCTION. SHOULD FOUNDATIONS BE STRUCK WITHIN THE 1 m DEPTH, THE TRIAL PIT CAN BE STOPPED AND INSPECTED BY THE ENGINEER.

PROPOSED FOUNDATIONS FOR COLUMN TO BE REVIEWED AND CONFIRMED FOLLOWING INVESTIGATIONS.

REV	DESCRIPTION	BY	DATE
P1	PRELIMINARY ISSUE	JB	12/08/25
P-PRELIMINARY T-TENDER CONSTRUCTION			

PROJECT

PRIMROSE HILL

TITLE

PROPOSED STRUCTURAL WORKS - GROUND FLOOR PLAN



MANN WILLIAMS
CONSULTING CIVIL AND
STRUCTURAL ENGINEERS

53 MOUNT STUART SQUARE
CARDIFF CF10 5LR
T 02920 480333
F 02920 435920
E cardiff@mannwilliams.co.uk

DRAWN	CHKD	SIZE	SCALE	DATE
JB	PR	A3	1:100	12/08/25

STATUS		
PRELIMINARY		
PROJECT	DRAWING	REV
9684	SK-19	P1